

#### **PRODUCT DESCRIPTION**

The MexFil™ WED200 UF075 ultrafiltration elements can be used for:

- Applications to treat ground and surface water, and for reuse of industrial or municipal wastewater effluents;
- The removal of particles, turbidity, TOC, bacteria, and viruses;
- Production of potable water and process water;
- Inside-out operation, typically in a semi dead-end filtration mode, cleaning by a regular backwash supported by a chemically enhanced backwash, providing perfect control of the membrane fouling rate;
- Horizontal installation inside a pressure vessel being plug-and-play compatible for the replacement of elements in existing installations.

The unique hollow fiber UF075 ultrafiltration membrane has an average pore size of less than 15 nm providing an improved fouling behaviour compared to existing ultrafiltration membranes.

#### **MEMBRANE SPECIFICATIONS**

Membrane material	Modified PES
Nominal MWCO*	75,000 Da
Membrane charge	Negative charge @ pH=7
Nominal fiber ID	0.8 mm

\* Molecular Weight Cut-Off (MWCO) is an estimation as it depends on size, shape, charge and polarity of the compound being tested as well as the test conditions.

#### **ELEMENT SPECIFICATIONS**

##### **Dimensions**

Length (L1)	1528 mm
Outer diameter housing (D1)	200 mm (8 inch)
Inner diameter permeate tube (d1)	42 mm
Nominal membrane area	40 m <sup>2</sup>

##### **Connections**

Type	Interconnectors (available on request) End connectors (pressure vessel specific dimensions)
------	--

##### **Materials of constructions**

Housing	PVC-U Cream
Internals	ABS/PP
Potting material	Epoxy resin

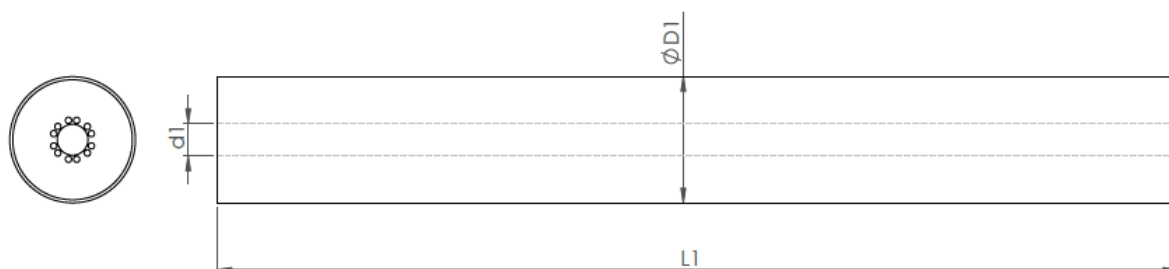

#### **PRODUCT CERTIFICATION**

According to NSF, KTW and Kiwa ATA regulations.